

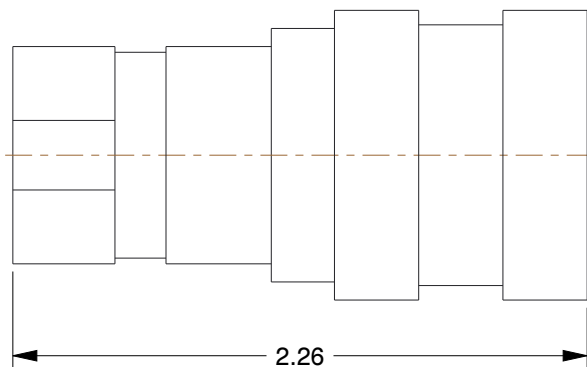

Series	Parker 60 Series	Coupler Body Size	1/4"
Valve Design	Poppet	Coupler Flow Rate	3.0 gpm
Seal Material	Buna	Locking Mechanism	Ball
Max. Pressure	2000 psi	Coupler Thread Size	1/4"-18
Coupler Finish	Plain	Coupler Body Material	303 Stainless Steel
Connection Type	FNPT	Quick Coupler Type	Hydraulic Coupler Body

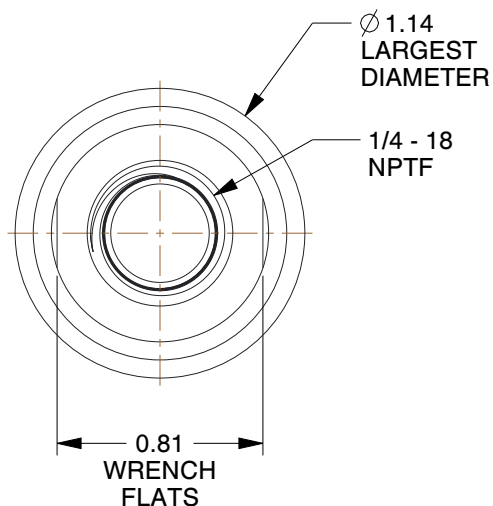

- NOTES:**
1. SHUT OFF: Double
 2. INCLUDES: Sleeve Lock
 3. ITEM: Hydraulic Coupler Body
 4. STANDARDS: ISO 7241-1 Series B
 5. PARKER INTERCHANGE: SH2-62
 6. BEARING MATERIAL: Stainless Steel
 7. SLEEVE MATERIAL: 303 Stainless Steel
 8. OPERATING TEMP. RANGE: -40° to 250°F
 9. FOR USE WITH: ISO 7241-1 Series B Nipple
 10. COUPLER INTERCHANGE TYPE: ISO 7241-1 Series B

COMPONENT	Hydraulic Quick Couplers		
<div>31A864</div> <div>Coupler Body, 1/4-18, 1/4 In. Body, 303 SS</div>	UNIT		
	INCH		
	SHEET		
	1 of 1		

GRAINGER
 100 Grainger Parkway, Lake Forest, Illinois 60045-5201
 1-(800) GRAINGER, 1-(800) 472-4643, (847) 535-1000
 www.grainger.com

This file and any associated information and specifications are provided for reference and evaluation purposes only, and is subject to change without notice. Grainger makes no representations, warranties or guarantees as to the appropriateness, accuracy, completeness, or suitability for any purpose, of the file, information or specifications. You are solely responsible for the use of the file, information or specifications.

This drawing is the property of GRAINGER. It contains confidential, proprietary information that is GRAINGER property. Do not disclose to or duplicate for others except as authorized by GRAINGER.

SCALE 1.32