

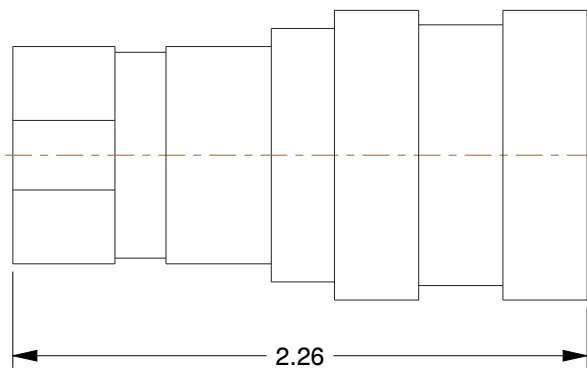

Series	Parker 60 Series	Coupler Body Size	1/4"
Valve Design	Poppet	Coupler Flow Rate	3.0 gpm
Seal Material	Buna	Locking Mechanism	Ball
Max. Pressure	5000 psi	Coupler Thread Size	1/4"-18
Coupler Finish	Zinc Plated	Coupler Body Material	Steel
Connection Type	FNPT	Quick Coupler Type	Hydraulic Coupler Body

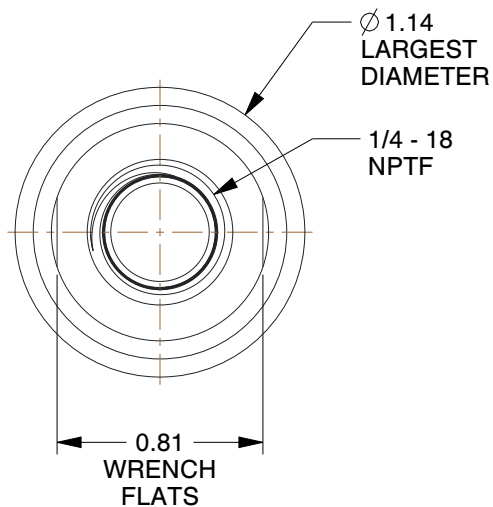

NOTES:

1. SHUT OFF: Double
2. SLEEVE MATERIAL: Steel
3. ITEM: Hydraulic Coupler Body
4. STANDARDS: ISO 7241-1 Series B
5. PARKER INTERCHANGE: H2-62
6. BEARING MATERIAL: Stainless Steel
7. OPERATING TEMP. RANGE: -40° to 250°F
8. FOR USE WITH: ISO 7241-1 Series B Nipple
9. INCLUDES: Sleeve-Lock, Valve Actuator, Steam
10. COUPLER INTERCHANGE TYPE: ISO 7241-1 Series B

COMPONENT

Hydraulic Quick Couplers

UNIT

INCH

SHEET

1 of 1

GRAINGER

100 Grainger Parkway, Lake Forest, Illinois 60045-5201
 1-(800) GRAINGER, 1-(800) 472-4643, (847) 535-1000
 www.grainger.com

This file and any associated information and specifications are provided for reference and evaluation purposes only, and is subject to change without notice. Grainger makes no representations, warranties or guarantees as to the appropriateness, accuracy, completeness, or suitability for any purpose, of the file, information or specifications. You are solely responsible for the use of the file, information or specifications.

This drawing is the property of GRAINGER. It contains confidential, proprietary information that is GRAINGER property. Do not disclose to or duplicate for others except as authorized by GRAINGER.

SCALE

1.32

31A853

Coupler Body, 1/4-18, 1/4 In. Body, Steel