

STANLEY

PROTO®

DEEP THIN WALL IMPACT SOCKETS



- Deep, thin wall sockets are specifically designed for special tight clearance applications; making it easier to access the fastener and to help improve productivity.
- Socket wall thickness is reduced to help improve access to fasteners in restricted areas. Thin wall sockets are recommended in difficult to access areas which require low impact force or in low usage frequency situations.
- Thin wall sockets weigh less than standard impact sockets.
- All impact sockets feature one through hole and a groove to accept a retaining ring and pin to secure the socket to the power tool anvil.
- Proto® impact sockets feature chamfered service ends for quick and positive fastener engagement.
- Proto® impact sockets incorporate the TorquePlus™ wrench system, allowing the socket to contact the fastener away from the corner while also dispensing stress over a larger area. This system allows for up to 15% more torque to be applied to the fastener reducing fastener rounding and an advantage to turn worn or rounded fasteners.

3/8" THIN WALL DEEP IMPACT SAE

| Product ID No. | A Inches | B Inches | C Inches | D Inches | E Inches | L Inches | Weight Lbs. |
|----------------|----------|----------|----------|----------|----------|----------|-------------|
| 7708HT | 1/4" | 13/32" | 11/16" | 15/64" | 7/32" | 2" | 0.1 |
| 7710HT | 5/16" | 31/64" | 11/16" | 17/64" | 17/64" | 2" | 0.1 |
| 7711HT | 11/32" | 1/2" | 11/16" | 9/32" | 9/32" | 2" | 0.1 |
| 7712HT | 3/8" | 37/64" | 11/16" | 3/8" | 45/64" | 1-24/32" | 0.1 |
| 7714HT | 7/16" | 5/8" | 11/16" | 3/8" | 45/64" | 1-24/32" | 0.2 |
| 7716HT | 1/2" | 23/32" | 23/32" | 9/16" | 1-7/64" | 1 51/64 | 0.2 |
| 7718HT | 9/16" | 25/32" | 25/32" | 39/64" | 1-19/64" | 2" | 0.2 |
| 7720HT | 5/8" | 7/8" | 7/8" | 43/64" | 1-15/32" | 2-7/64" | 0.3 |
| 7722HT | 11/16" | 15/16" | 15/16" | 43/64" | 1-1/2" | 2-7/32" | 0.3 |
| 7724HT | 3/4" | 1" | 1" | 43/64" | 1-35/64" | 2-15/64" | 0.4 |
| 7728HT | 7/8" | 1-3/16" | 1-3/16" | 45/64" | 1-51/64" | 2-1/2" | 0.4 |
| 7730HT | 15/16" | 1-1/4" | 1-1/4" | 7/8" | 2-13/64" | 2-27/32" | 0.5 |

3/8" THIN WALL DEEP IMPACT METRIC

| Product ID No. | A Inches | B Inches | C Inches | D Inches | E Inches | L Inches | Weight Grams |
|----------------|----------|----------|----------|----------|----------|----------|--------------|
| 7008MHT | 8mm | 1/2" | 59/86" | 1/3" | 39/55" | 1-3/4" | 49.6 |
| 7009MHT | 9mm | 5/16" | 11/16" | 5/16" | 11/16" | 2" | 65.0 |
| 7010MHT | 10mm | 13/22" | 19/32" | 19/32" | 19/32" | 1-3/4" | 65.0 |
| 7011MHT | 11mm | 11/16" | 11/16" | 21/64" | 11/16" | 2" | 60.0 |
| 7012MHT | 12mm | 11/16" | 11/16" | 7/16" | 1-7/64" | 1-3/4" | 75.0 |
| 7013MHT | 13mm | 23/32" | 23/32" | 33/64" | 1-7/64" | 1-3/4" | 85.0 |
| 7014MHT | 14mm | 25/32" | 25/32" | 1/2" | 1" | 1-3/4" | 80.0 |
| 7015MHT | 15mm | 53/64" | 53/64" | 11/16" | 1-15/32" | 2" | 95.3 |
| 7016MHT | 16mm | 27/32" | 27/32" | 23/32" | 1-15/32" | 2" | 119.8 |
| 7017MHT | 17mm | 59/64" | 59/64" | 23/32" | 1-15/32" | 2" | 136.4 |
| 7018MHT | 18mm | 59/64" | 59/64" | 23/32" | 1-15/32" | 2" | 136.4 |
| 7019MHT | 19mm | 1" | 1" | 23/32" | 1-15/32" | 2" | 144.6 |

1/2" THIN WALL DEEP IMPACT SOCKETS SAE

| Product ID No. | A Inches | B Inches | C Inches | D Inches | E Inches | L Inches | Weight Lbs. |
|----------------|----------|----------|----------|----------|----------|----------|-------------|
| J7312HT | 3/8" | 9/16" | 15/16" | 5/16" | 2" | 3-1/4" | 0.3 |
| J7314HT | 7/16" | 21/32" | 15/16" | 11/32" | 2" | 3-1/4" | 0.4 |
| J7316HT | 1/2" | 23/32" | 15/16" | 7/16" | 2" | 3-1/4" | 0.4 |
| J7318HT | 9/16" | 13/16" | 15/16" | 1/2" | 2" | 3-1/4" | 0.4 |
| J7320HT | 5/8" | 7/8" | 15/16" | 9/16" | 2" | 3-1/4" | 0.4 |
| J7322HT | 11/16" | 31/32" | 31/32" | 41/64" | 2" | 3-1/4" | 0.4 |
| J7324HT | 3/4" | 1" | 1" | 1-3/16" | 2" | 3-1/4" | 0.5 |
| J7326HT | 13/16" | 1-1/8" | 1-1/8" | 1-5/32" | 2-1/8" | 3-1/4" | 0.5 |
| J7328HT | 7/8" | 1-3/16" | 1-3/16" | 1-11/32" | 2-7/16" | 3-1/2" | 0.5 |
| J7330HT | 15/16" | 1-1/4" | 1-1/4" | 1-27/64" | 2-7/16" | 3-1/2" | 0.7 |
| J7332HT | 1" | 1-3/8" | 1-3/8" | 1-27/64" | 2-7/16" | 3-1/2" | 0.8 |
| J7334HT | 7/16" | 1-31/64" | 1-31/64" | 1-35/64" | 2-7/16" | 3-1/2" | 1.0 |
| J7336HT | 9/8" | 1-9/16" | 1-9/16" | 1-15/32" | 2-7/16" | 3-1/2" | 1.0 |
| J7338HT | 1-3/16" | 1-5/8" | 1-5/8" | 1-27/64" | 2-7/16" | 3-1/2" | 1.1 |
| J7340HT | 1-1/4" | 1-23/32" | 1-23/32" | 1-27/64" | 2-7/16" | 3-1/2" | 1.2 |
| J7342HT | 1-5/16" | 1-25/32" | 1-25/32" | 1-27/64" | 2-7/16" | 3-1/2" | 1.3 |
| J7344HT | 1-3/8" | 1-27/32" | 1-27/32" | 1-27/64" | 2-7/16" | 3-1/2" | 1.3 |
| J7346HT | 1-7/16" | 1-15/16" | 1-15/16" | 1-27/64" | 2-7/16" | 3-1/2" | 1.5 |
| J7348HT | 1-1/2" | 1-31/32" | 1-31/32" | 1-27/64" | 2-7/16" | 3-1/2" | 1.7 |

1/2" THIN WALL DEEP IMPACT SOCKETS METRIC

| Product ID No. | A Inches | B Inches | C Inches | D Inches | E Inches | L Inches | Weight Grams |
|----------------|----------|----------|----------|----------|----------|----------|--------------|
| J7310MHT | 10mm | 39/64" | 15/16" | 3/8" | 2" | 3-1/4" | 136.2 |
| J7311MHT | 11mm | 21/32" | 15/16" | 13/32" | 2" | 3-1/4" | 145.0 |
| J7312MHT | 12mm | 11/16" | 15/16" | 33/64" | 2" | 3-1/4" | 154.0 |
| J7313MHT | 13mm | 47/64" | 15/16" | 33/64" | 2" | 3-1/4" | 154.0 |
| J7314MHT | 14mm | 13/16" | 15/16" | 1/2" | 2" | 3-1/4" | 159.0 |
| J7315MHT | 15mm | 27/32" | 15/16" | 33/64" | 2" | 3-1/4" | 165.0 |
| J7316MHT | 16mm | 7/8" | 15/16" | 39/64" | 2" | 3-1/4" | 193.0 |
| J7317MHT | 17mm | 15/16" | 15/16" | 5/8" | 2" | 3-1/4" | 200.0 |
| J7318MHT | 18mm | 1" | 1" | 45/64" | 2" | 3-1/4" | 210.0 |
| J7319MHT | 19mm | 1-1/32" | 1-1/32" | 27/32" | 2" | 3-1/4" | 229.0 |
| J7320MHT | 20mm | 1-1/16" | 1-1/16" | 1-3/16" | 2" | 3-1/4" | 235.0 |
| J7321MHT | 21mm | 1-1/8" | 1-1/8" | 1-3/16" | 2" | 3-1/4" | 240.0 |
| J7322MHT | 22mm | 1-3/16" | 1-3/16" | 1-3/16" | 2" | 3-1/4" | 330.0 |
| J7323MHT | 23mm | 1-1/4" | 1-1/4" | 1-3/16" | 2" | 3-1/4" | 355.7 |
| J7324MHT | 24mm | 1-5/16" | 1-5/16" | 1-5/32" | 2" | 3-1/4" | 381.4 |
| J7330MHT | 30mm | 1-3/4" | 1-5/8" | 1-13/32" | 2" | 3-1/2" | 420.0 |

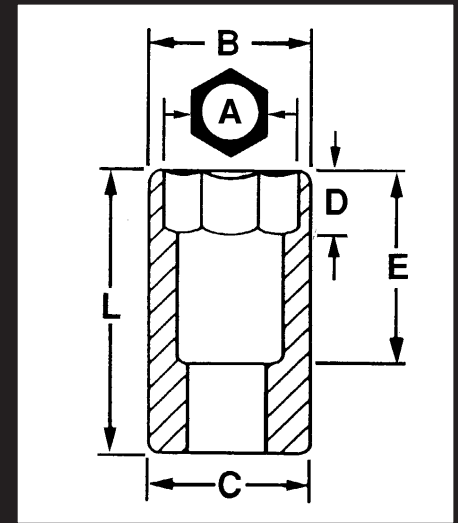

Measurement Key

