

# Lumination™ LED Luminaire

(RX Series)

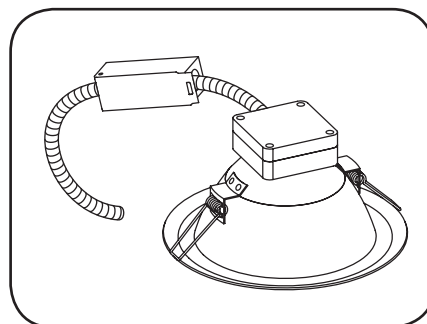

## BEFORE YOU BEGIN

Read these instructions completely and carefully.

### ⚠ WARNING/AVERTISSEMENT

#### RISK OF FIRE OR ELECTRIC SHOCK

- Turn power off before inspection, installation or removal.
- Install this kit only in the luminaires that has the construction features and dimensions shown in the photographs and/or drawings.
- Installation of this retrofit assembly requires a person familiar with the construction and operation of the luminaire's electrical system and the hazard involved. If not qualified, do not attempt installation. Contact a qualified electrician.
- To prevent wiring damage or abrasion, do not expose wiring to edges of sheet metal or other sharp objects.
- Do not make or alter any open holes in an enclosure of wiring or electrical components during kit installation.

#### RISQUES D'INCENDIE OU DE DÉCHARGES ÉLECTRIQUES

- Coupez l'alimentation avant d'inspecter, installer ou déplacer le luminaire.
- Risques d'incendie ou choc L'installation de trousse de mise à niveau ou DEL nécessite des connaissances des systèmes électriques d'éclairage.
- Risque d'incendie ou d'électrocution. N'installez cette trousse que sur des luminaires qui ont les caractéristiques de construction et les dimensions telles que montrées sur les photographies et dessins présentés.
- Pour prévenir les dommages ou l'abrasion de fils électriques, ne pas exposer les fils aux arêtes de pièce de tôle ou n'importe quels autres objets tranchant.
- Ne pas percer ou altérer les trous d'un boîtier contenant fil ou composant électrique durant l'installation.

### ⚠ CAUTION/ATTENTION

- Fixture may fall down if not installed properly, follow installation instructions.
- Wear safety glasses and proper aid during installation and maintenance.
- Use only UL certified wire, wire connectors, minimum 18AWG, minimum rated 105°C.

- Le luminaire peut tomber s'il n'est pas installé correctement, suivre les instructions d'installation.
- Porter des lunettes de sécurité et les aides appropriées lors de l'installation et de l'entretien.
- N'utilisez que des fils approuvés par UL pour les entrées/sorties de connexion. Calibre minimum 18 AWG (0.75mm<sup>2</sup>) et température minimale de 105°C.

## Save These Instructions

Use only in the manner intended by the manufacturer. If you have any questions, contact the manufacturer.

The retrofit kit is accepted as a component of a luminaire where the suitability of the combination shall be determined by UL or authorities having jurisdiction.



imagination at work

# Prepare Electrical Wiring



## Electrical Requirements

- The luminaire must be supplied with 120-277 VAC, 50/60 Hz.
- Connected to an individual properly grounded branch circuit, protected by a 15 or 20 ampere circuit breaker. Use min. 105°C supply conductor.



## Grounding Instructions

The grounding and bonding of the overall system shall be done in accordance with National Electric Code (NEC) Article 600 and local codes.

# Fixture Requirements

The units covered by this install instruction are intended to retrofit Listed surface mounted luminaires, as well as type Non-IC recessed mounted fluorescent type luminaires. The products are intended to be used in dry and damp locations only.

# Provided Components

The components have been properly packed to avoid damage during transit. Inspect the components to confirm there is no physical damage. Do not install damaged components.

The carton consists of:

1. Recessed LED Retrofit Assembly
2. Instruction sheet

# Luminaire Installation

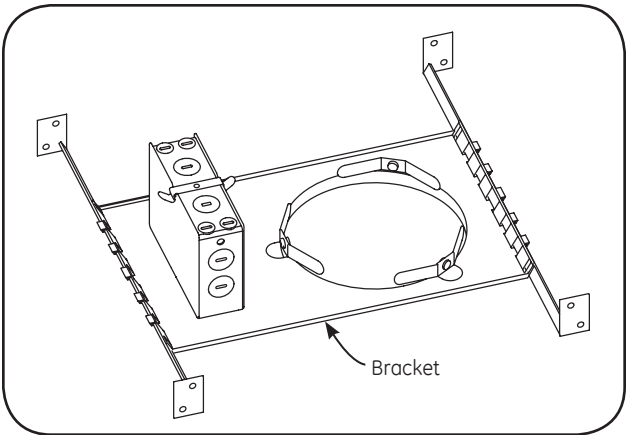

- 1** Before retrofit, verify that the junction box and bracket in the existing installation are metal and are constructed similarly to the illustration at left.

Frame Size (in.)	Bracket Dimensions (in.)	Hole Size (in.)	Suitable Fixture
6	12.60 x 7.64 x 3.54	5.91–6.50	RX6xxxxxMV
8	15.55 x 11.34 x 3.54	7.68–8.27	RX8xxxxxMV

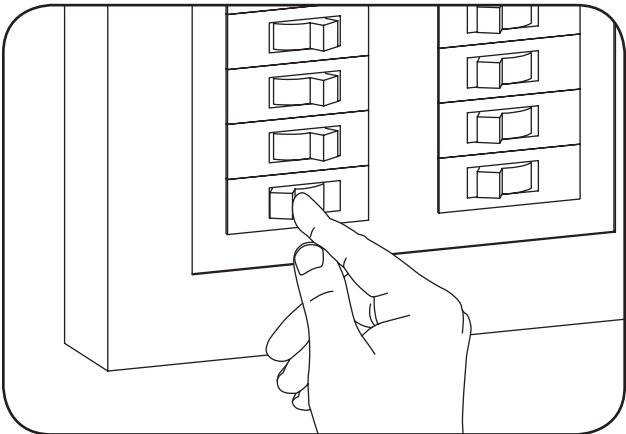

- 2** Ensure that the power to the unit is turned off. Use proper lockout and tagout procedures.

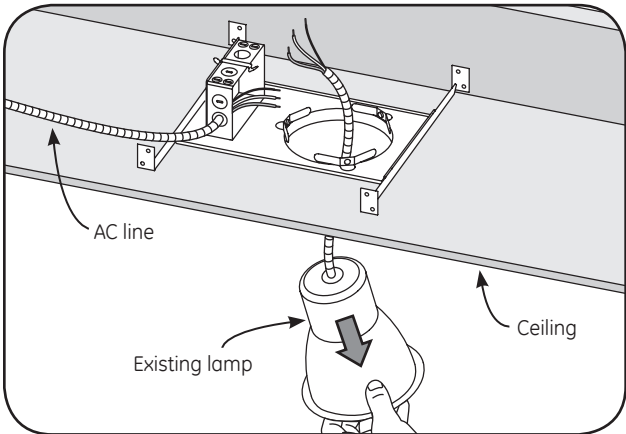

- 3** Remove existing lamps, ballast and reflector. Leave wiring in junction box. Verify that the AC supply line is provided with a ground wire connected to the luminaire.

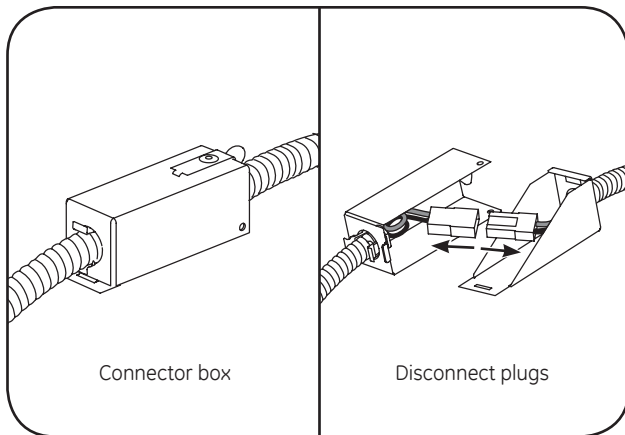

- 4** Disassemble the connector box and unplug the two quick connectors inside.

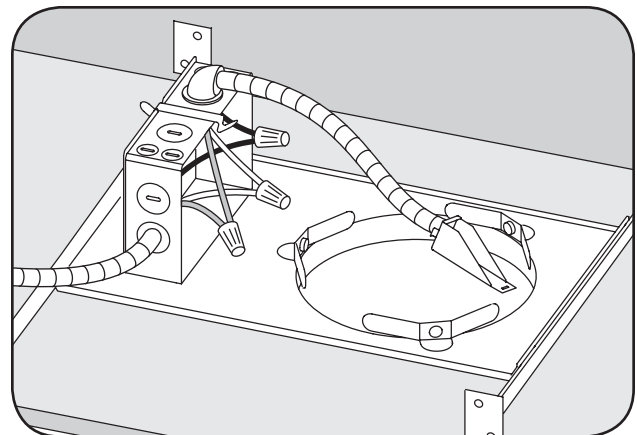

- 5** Connect conduit fitting to the existing junction box. Connect the black, white and green yellow wires of the input leads to the black, white and green AC line wires using UL Listed twist-on wire connectors and close the junction box.

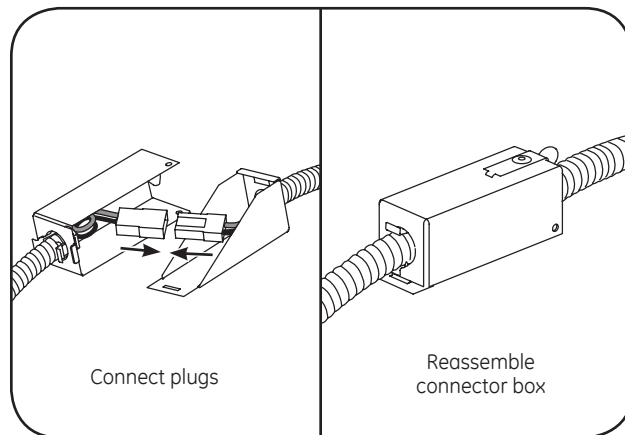

- 6** Connect the two quick connectors and reassemble the connector box.

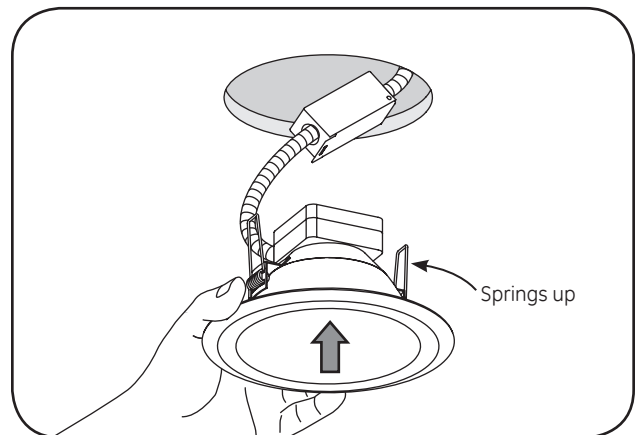

- 7** Load springs into upright position by twisting the springs upward and carefully insert the fixture to the hole of the frame. Ensure fixture is secure.

This device complies with Part 15 of the FCC Rules. Operation is subject to the following two conditions: (1) This device may not cause harmful interference, and (2) this device must accept any interference received, including interference that may cause undesired operation. This Class [A] RFLD complies with the Canadian standard ICES-003. Ce DEFR de la classe [A] est conforme à la NMB-003 du Canada.

**Note:** This equipment has been tested and found to comply with the limits for a Class A digital device, pursuant to part 15 of the FCC Rules. These limits are designed to provide reasonable protection against harmful interference when the equipment is operated in a commercial environment. This equipment generates, uses, and can radiate radio frequency energy and, if not installed and used in accordance with the instruction manual, may cause harmful interference to radio communications. Operation of this equipment in a residential area is likely to cause harmful interference in which case the user will be required to correct the interference at his own expense.



[www.gelighting.com](http://www.gelighting.com)

GE and the GE Monogram are trademarks of the General Electric Company. All other trademarks are the property of their respective owners. Information provided is subject to change without notice. All values are design or typical values when measured under laboratory conditions. GE Lighting is a business of the General Electric Company. © 2015 GE.

IND209 (Rev 10/30/15)