

94A Series

Full Port Brass Ball Valve

SUBMITTAL SHEET

"Apollo" Flow Controls



Job Name:	
Job Location:	
Engineer:	
Contractor:	
Tag:	
PO#:	
Rep:	
Wholesale Dist.:	

DESCRIPTION

The Apollo International™ 94A Forged Brass Ball Valve combines reliable operation with maximum economy. Ideal for general flow control applications including HVAC, fuel gases, and fire protection trim and drain etc. Valves include most pertinent agency approvals.

FEATURES

- 2-Piece, Full Port Design
- Blowout-Proof Stem
- Adjustable Stem Packing Nut
- 100% Factory Tested
- Stem Seal O-Ring (Solder Version 1/2" - 2")

PERFORMANCE RATING

- 600 CWP - 1/4" to 2"
- 400 CWP - 2-1/2" to 4"
- Temperature Range: 0°F to 400°F

APPROVALS

- MSS SP-110 - Ball Valves

CSA LISTED

- (File # 226234) per the following standards:
- ANSI Z21.15 (1/2 psi) (CSA 9.1) (1/4" - 2")
 - ASME B16.44 (5 psi) (CR91-002) (1/4" - 2")
 - ASME B16.33 (125 psi) (CGA 3.16) (1/4" - 2")

UL LISTED

- Guides YQNZ, YRBX, YRPV, YSDT and MHKZ (1/4" - 4" NPT only)
- UL 258 - VQGU Fire Protection Trim & Drain 175psi max (1/4" - 2")

FM LISTED

- FM 1140 Fire Protection Quick Opening Valves

***Gas approvals apply to NPT models only**
***Not for use in potable water applications in the United States.**

STANDARD MATERIALS LIST

Body	Forged Brass (Cu >57%)
Retainer	Forged Brass (Cu >57%)
Ball	Brass, Cr plated
Stem	Brass, Cr plated
Stem Seal/O-Ring	EPDM
Seats	PTFE
Stem Packing	PTFE
Gland Nut	Brass
Handle	Steel, Plated (with PVC Grip)
Handle Nut	Steel, Plated

**94A-2xx intended for soft solder installation using solders with melting temperature < 500°F.

DIMENSIONS

PART NUMBER	SIZE (IN.)	DIMENSIONS (IN.)					WT. (LBS.)	KIT OPTIONS	
		A	B	C	D	E		2-1/4" STEM EXTENSION + MEMORY STOP	REPLACEMENT LEVER HANDLES
NPT									
94A-101-01	1/4"	0.395	1.746	1.840	3.543	-	0.3	78217101	W932400
94A-102-01	3/8"	0.407	1.756	1.840	3.543	-	0.3		
94A-103-01	1/2"	0.583	2.047	1.921	3.543	-	0.5	78217201	W932500
94A-104-01	3/4"	0.748	2.362	2.087	3.780	-	0.7	78217301	W936000
94A-105-01	1"	0.945	2.756	2.559	4.528	-	1.1	78217401	W932600
94A-106-01	1-1/4"	1.260	3.307	2.953	4.528	-	1.6	78217501	W932700
94A-107-01	1-1/2"	1.575	3.661	3.346	5.512	-	2.4	78217601	W932800
94A-108-01	2"	1.969	4.181	3.681	5.512	-	3.4		W233200
94A-109-01	2-1/2"	2.520	5.378	4.764	8.661	-	7.6	78217701	W932900
94A-100-01	3"	2.953	6.039	5.079	8.661	-	9.3		
94A-10A-01	4"	3.898	7.386	5.866	9.606	-	16.9	78217801	W933000
SOLDER									
94A-203-01	1/2"	0.583	2.047	1.839	3.543	0.630	0.3	78217201	W932500
94A-204-01	3/4"	0.748	2.748	1.996	3.780	0.878	0.6	78217301	W936000
94A-205-01	1"	0.945	3.228	2.441	4.528	1.130	1.0	78217401	W932600
94A-206-01	1-1/4"	1.260	3.819	2.854	4.528	1.378	1.4	78217501	W932700
94A-207-01	1-1/2"	1.575	4.425	3.169	5.512	1.630	2.2	78217601	W932800
94A-208-01	2"	1.969	5.315	3.449	5.512	2.130	3.0		W233200
94A-209-01	2-1/2"	2.520	6.283	4.764	8.661	2.630	6.4	78217701	W932900
94A-200-01	3"	2.953	7.150	5.079	8.661	3.130	8.5		
94A-20A-01	4"	3.945	9.276	5.866	9.606	4.130	15.8	78217801	W933000

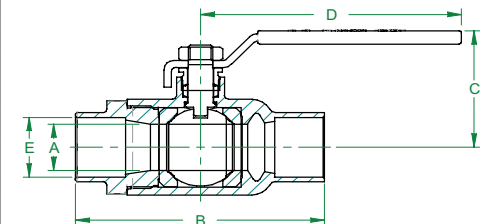
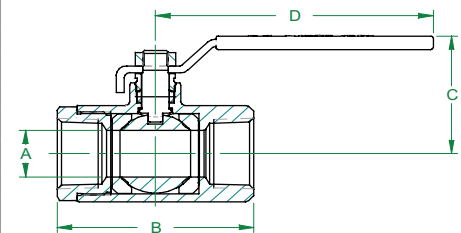

Customer Service (704) 841-6000
www.apolloflowcontrols.com

This specification is provided for reference only. Conbraco Industries Inc. reserves the right to change any portion of this specification without notice and without incurring obligation to make such changes to Conbraco products previously or subsequently sold. Please visit apolloflowcontrols.com for the most current information.

